

LONGWALL SALVAGE PACK

RMI supply self contained longwall salvage units for hire and sale in New South Wales and Queensland. RMI salvage units are fitted with an extensive range of safety features for a compact, stand alone unit, providing protection for personnel and equipment.

FORKLIFT SLOTS

TO PROVIDE EASY AND SAFE
TRANSPORTATION AROUND
THE MINE SITE

ADJUSTABLE LEGS

TO ENSURE THE UNIT IS
SET LEVEL FOR OPTIMUM
OPERATION.

Optimised for operations within a mining environment, RMI's self contained longwall salvage units offer unparalleled safety and reliability.

TYPICAL PERFORMANCE DATA

Flow of 202 l/min @ 240 - 350 Bar
Pump - Trimax S300
Motor Power 110 - 132 kW

KEY FEATURES & BENEFITS

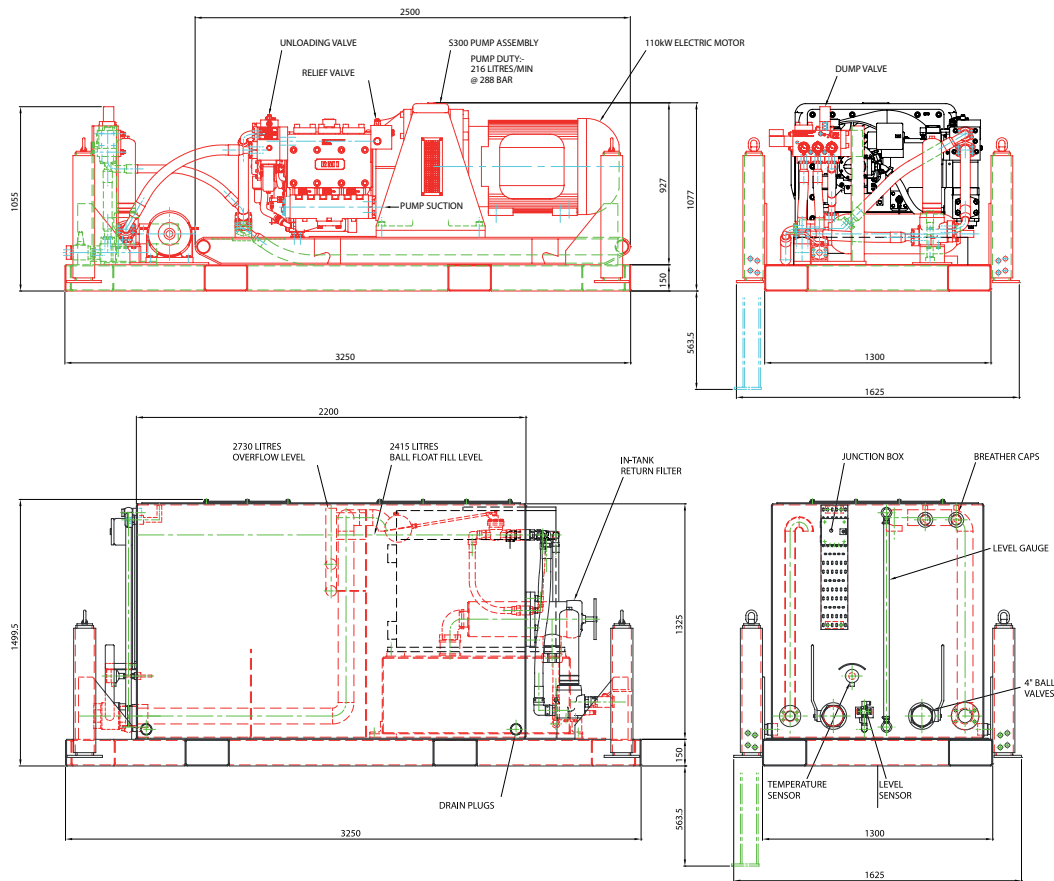

CONSTRUCTION

The pump and tank assemblies are fitted with manually adjustable legs to ensure the pump works in optimum position, Maintaining correct fluid levels in the emulsion and oil tanks.

The tank assembly is complete with water inlet and emulsion in-tank return filters to ensure the pump medium is kept clear to prolong component life.

FEATURES

1000V power supply, complete with starter unit

Fully compliant for use in NSW and QLD

Fully flameproof

MDG41 compliant

Strobe lighting when in operation

Dump valve installed on each unit

Setup for raw or premixed solution

Remote stop/start facility

Training and all documentation supplied with each unit

Ref: 1146/08/2015

rmi **ARMSTRONG** 

MANCHESTER

1 WOLVERTON STREET
MANCHESTER, M11 2ET
UNITED KINGDOM

+44 (0) 161 274 2451

AUSTRALIA

40 ARUMA PLACE
CARDIFF, NSW 2285
AUSTRALIA

+61 (02) 4954 0163

USA

6599 OLD BIRMINGHAM
HIGHWAY, JASPER, ALABAMA
35501-8216 US

+1 (205) 483 0350

CHINA

NO. 1619 HU HANG ROAD,
XI DU TOWNSHIP FENG XIAN
DISTRICT, SHANGHAI
CHINA 201401

+86 (0)21 3756 6696